

MARKING	SILL	LINTEL	SIZE
W1	300	2550	7150X2550
W2	300	2550	5000X2550
W3	300	2550	4325X2550
W4	300	2550	3900X2550
W5	300	2550	3850X2550
W6	300	2550	3500X2550
W7	300	2550	3600X2550
W8	300	2550	3600X2550
W9	300	2550	3500X2550
W10	300	2550	3300X2550
W11	300	2550	3225X2550
W12	300	2550	3050X2550
W13	300	2550	3000X2550
W14	300	2550	2900X2550
W15	300	2550	2800X2550
W16	300	2550	2750X2550
W17	300	2550	2650X2550
W18	300	2550	2400X2550
W19	300	2550	2250X2550
W20	300	2550	2000X2550
W21	300	2550	1800X2550
W22	300	2550	1875X2550
W23	300	2550	1825X2550
W24	300	2550	1700X2550
W25	300	2550	1650X2550
W26	300	2550	1650X2550
W27	300	2550	1650X2550
W28	300	2550	1650X2550
W29	300	2550	1600X2550
W30	300	2550	1550X2550
W31	300	2550	1400X2550
W32	300	2550	1325X2550
W33	300	2550	1300X2550
W34	300	2550	1225X2550
W35	300	2550	1150X2550
W36	300	2550	1120X2550
W37	300	2550	1100X2550
W38	300	2550	1000X2550
W39	300	2550	900X2550
W40	300	2550	800X2550
W41	300	2550	750X2550
W42	300	2550	700X2550

MARKING	SILL	LINTEL	SIZE
DA	2400	2400	1800X2400
DB	2400	2400	2000X2400
D1	2400	2400	1200X2400
D2	2400	2400	1000X2400
D3	2400	2400	900X2400
D4	2400	2400	750X2400
D5	2400	2400	700X2400
SD	2550	2550	5350X2550
SD1	2550	2550	1200X2550
RD	2400	2400	900X2400
DW1	2550	2550	7500X2550
DW2	2550	2550	7450X2550
DW3	2550	2550	7350X2550
DW4	2550	2550	7150X2550
DW5	2550	2550	6900X2550
DW6	2550	2550	4050X2550
DW7	2550	2550	3650X2550
DW7A	2550	2550	3850X2550
DW8	2550	2550	3000X2550
DW9	2550	2550	2750X2550
DW10	2550	2550	2650X2550
DW11	2550	2550	2450X2550
DW12	2550	2550	2350X2550
DW13	2550	2550	2100X2550
DW14	2550	2550	1225X2550
FGD	2400	2400	1200X2400
DW15	2550	2550	900X2550
DW16	2550	2550	6000X2550

MARKING	SILL	LINTEL	SIZE
F.G.2	2550	2550	1150X2550
CG2A	2550	2550	15800X2550
CG2	2550	2550	15800X2550
CG3A	2550	2550	13400X2550
CG3	2550	2550	12725X2550
CG4	2550	2550	11630X2550
CG4A	2550	2550	11400X2550
CG5	2550	2550	11200X2550
CG6	2550	2550	8600X2550
CG7	2550	2550	8425X2550
CG8A	2550	2550	775X2550
CG8	2550	2550	775X2550
CG9	2550	2550	7450X2550
CG10	2550	2550	7175X2550
CG11	2550	2550	6500X2550
CG12	2550	2550	6225X2550
CG12A	2550	2550	6050X2550
CG13	2550	2550	5975X2550
CG14	2550	2550	5875X2550
CG15	2550	2550	5750X2550
CG16	2550	2550	5300X2550
CG17	2550	2550	5300X2550
CG18	2550	2550	5250X2550
CG19	2550	2550	5100X2550
CG19A	2550	2550	4800X2550
CG20	2550	2550	4700X2550
CG21	2550	2550	4525X2550
CG22	2550	2550	4250X2550
CG23	2550	2550	4050X2550
CG24	2550	2550	3950X2550
CG25	2550	2550	3550X2550
CG26	2550	2550	3500X2550
CG27	2550	2550	3150X2550
CG28	2550	2550	2800X2550
CG29A	2550	2550	2000X2550
CG30	2550	2550	1600X2550
CG31	2550	2550	1500X2550
CG32	2550	2550	1400X2550
CG33	2550	2550	6000X2550
CG34	2550	2550	4425X2550
CG35	2550	2550	3000X2550
CG37	2550	2550	4105X2550
CG46	2550	2550	1300X2550
CG50	2550	2550	3450X2550
CG51	2550	2550	1925X2550

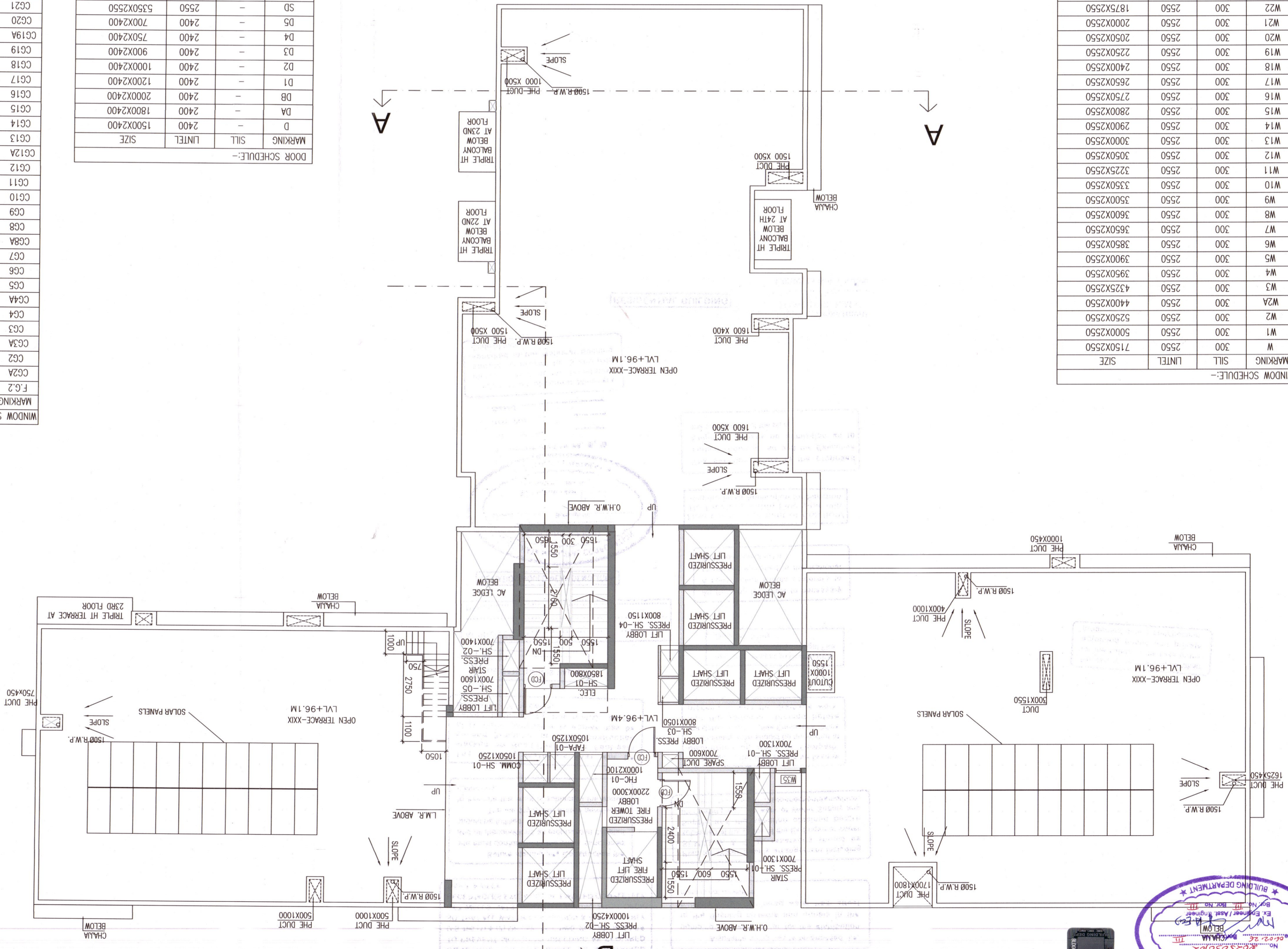

TOWER 1 - ROOF PLAN
1:100

A

A

B



GENERAL NOTES

1. ALL DIMENSIONS ARE IN MM.
2. ALL EXTERNAL WALLS 200THK. & INTERNAL WALLS 100THK. UNLESS OTHERWISE MENTIONED.
3. ALL MASONRY WORKS ARE BOUND BY CEMENT MORTAR (1:6) & (1:4).
4. EXTERNAL PLASTER IS 25 THK. & INTERNAL PLASTER IS 12MM THK. WITH 1:4 MORTAR.
5. ALL CONC. GRADE IS 2000 (1:1.5:3).

IT IS CERTIFIED THAT THE COMPREHENSIVE GEO-TECHNICAL REPORT ON SOIL INVESTIGATION HAS BEEN PREPARED BY ME FOR DESIGN AND CALCULATION OF THE FOUNDATION WHICH FOUNDATION OF THE STRUCTURE WILL BE CONSTRUCTED. BY ANALYZING THE SOIL SAMPLE FOR ESTIMATING THE BEARING CAPACITY OF THE SOIL. I SHALL ALSO CHECK THE NATURE OF THE SOIL AFTER EXCAVATION AT SITE SO THAT FOUNDATION IS EXTENDED UP TO APPROPRIATE DEPTH THAT HAS BEEN PROPOSED IN THE GEO-TECHNICAL REPORT.

CERTIFICATE OF GEO-TECHNICAL ENGINEER

Dr. Sujit Kumar Bose
P.H.D., M.C.E. (S&I), B.C.E. (Hons.), M.B.C. (Hons.), M.B.C. (Hons.)
Engineer Under K.M.C.
License No. G.T./1/12

CERTIFICATE OF OWNER

1. I ENGAGED ARCHITECT AND E.S.E. DURING CONSTRUCTION.
2. I FOLLOWED THE INSTRUCTIONS OF ARCHITECT AND E.S.E. DURING CONSTRUCTION OF THE BUILDING.
3. K.M.C. AUTHORITY WILL NOT BE RESPONSIBLE FOR STRUCTURE.
4. IF ANY SUBMITTED DOCUMENT IS FOUND TO BE FAKE THE K.M.C. AUTHORITY MAY REVOKE THE SANCTION PLAN.
5. THE CONSTRUCTION OF WATER RESERVOIR AND CATCHMENT RECEIVED UNDER THE GUIDANCE OF ARCHITECT & E.S.E.

Authorised Signatory of
SOURAV GIRI
Director
Mr. Ashok Kumar Goenka &
M/s. Sunidhi Estates Pvt. Ltd.
For As Constituted Attorney of
M/s. Vitek Build Industries Pvt. Ltd.,
M/s. Mechano International Pvt. Ltd. &
M/s. Ushav Developers Pvt. Ltd. &
M/s. Eclivity Properties Pvt. Ltd.
Mr. Varun Goenka

CERTIFICATE OF ARCHITECT

THE L.B.A. HAS CERTIFIED ON THE PLAN WITH FULL RESPONSIBILITY THAT THE BUILDING PLAN HAS BEEN DRAWN UP AS PER PROVISION OF K.M.C. BLDG. RULES 2009, AS AMENDED FROM TIME TO TIME AND THAT THE SITE CONDITION INCLUDING THE WIDTH OF THE ADJOINING ROAD CONFORM WITH THE PLAN AND IT IS A BUILDABLE SITE AND NOT A TANK OR A FILLED UP TANK.

MANASH KUMAR SINHA ROY
Registered Architect
Regd. No. CA/2011/54201
MANASH KUMAR SINHA ROY
Registered Architect
Regd. No. CA/2011/54201

CERTIFICATE OF STRUCTURAL ENGINEER

Mr. Omkar Sharma
License No. - ESE/KMCA/19/04
SRI/L/MCA/10/040

MS MITA SAHA
M.E. (Struct), C.E.
Structural Engineer - 92/23 (KMCA)

PROJECT

TOWER 1 - ROOF PLAN

TITLE

PROPOSED PLAN FOR ADDITIONAL 2 NOS. OF RESIDENTIAL TOWER-1 & 2(G-28) STORED(96.1 M HEIGHT), 1 NO. OF BUNGALOW(G+8) STORED(38M HEIGHT), 1 NO. OF VILLA(B+G+3) STORED(15.15M HEIGHT) BUILDING WITH NO. OF (G+3) STORED (12.45M HEIGHT) OFFICE BUILDING UNDER SECTION 394 OF K.M.C. ACT 1980, COMPLYING K.M.C. BUILDING RULES 2009 (AMENDED), ALONG WITH THE SANCTIONED (G+3) STORED(13M HEIGHT) RESIDENTIAL BUILDING AT PREMISES NO. 47, PREMISES NO. 53A, 53B, 67, 67/1C, 54A & 47, LAND AMALGAMATED ON DATED 09.02.2024) CANAL CIRCULAR ROAD, KOLKATA-700054, UNDER BOROUGH-III, P.S.-PHOOLBAGAN, KOLKATA-700054, UNDER KOLKATA MUNICIPAL CORPORATION.

VIDE SANCTION B.P. NO. 2017030061, DATED, 15.12.2017.

DATE: 10.09.2025
SCALE: 1:100
DRAWN BY: M.S.R.
DEALT BY: A.S.

PARTY'S COPY

CONSTRUCTION SITE SHALL BE MAINTAINED TO PREVENT MOSQUITO BREEDING AS REQUIRED U/S 496 (1) & (2) OF C.M.C. ACT 1980 IN SUCH MANNER SO THAT ALL WATER COLLECTION & PARTICULARLY LIFT WELLS, WATS, BASIN, CURBING STRES, OPEN RECEPTACLES ETC. MUST BE EMPTIED COMPLETELY TWICE A WEEK.

A suitable pump has to be provided i.e. pumping unfiltered water for the distribution to the flushing cisterns and urinals in the building incase unfiltered water from street main is not available.

Plan for Water Supply arrangement including S.M.L.I. G. & O. H. reservoirs should be submitted at the Office of the Executive Engineer. Supply and the sanction obtained before proceeding with the work of Water supply any deviation may lead to disconnection/damage.

Before starting any construction the site must conform with the plans sanctioned and all the conditions as proposed in the plan should be fulfilled. The validity of the written permission to execute the work is subject to the above conditions.

No rain water pipe should be fixed or discharged on Road or Footpath. Drainage plan should be submitted at the Borough Executive Engineer's Office and the sanction obtained before proceeding with the drainage work.

The building materials that will be stacked on Road/Passage or Foot-path beyond 3-months or after construction is started forthwith by the K.M.C. at the cost and risk of the owner.

Approved subject to Compliance of requisition of West Bengal Fire Services, if any.

THE SANCTION IS VALUED UP TO 5-02-2021

All Building Materials to necessary & construction should conform to the standard specified in the National Building Code of India.

APPROVED BY: M. B. C.
Dated: 18.08.2021

Non Commencement of Erection/ Re-Erection within Five year will Require Fresh Application for Sanction.



The sanction refers to the proposed portion shown in red and the Executive Engineers makes no admission as to the correctness of the plan.

Design of all Structural Members should conform to Standards specified in the National Building Code of India

Recommended by M. B. C.
Drawing No. 655
Licen No. 138/25-26
Dated: 18.08.2021

RESIDENTIAL BUILDING

Building Department
Borough-III, K.M.C.
Date: 18.08.2021
Contents Not Verified

20

Necessary steps should be taken for the safety of the use of the adjoining public and private properties during construction.

